

STEEL BAR GRATING
STAIR TREAD
W-19-4 1 1/4" x 3/16"
W/ CHECKER P NOISING &
1 1/4" WELD-IN SIDE PLATES

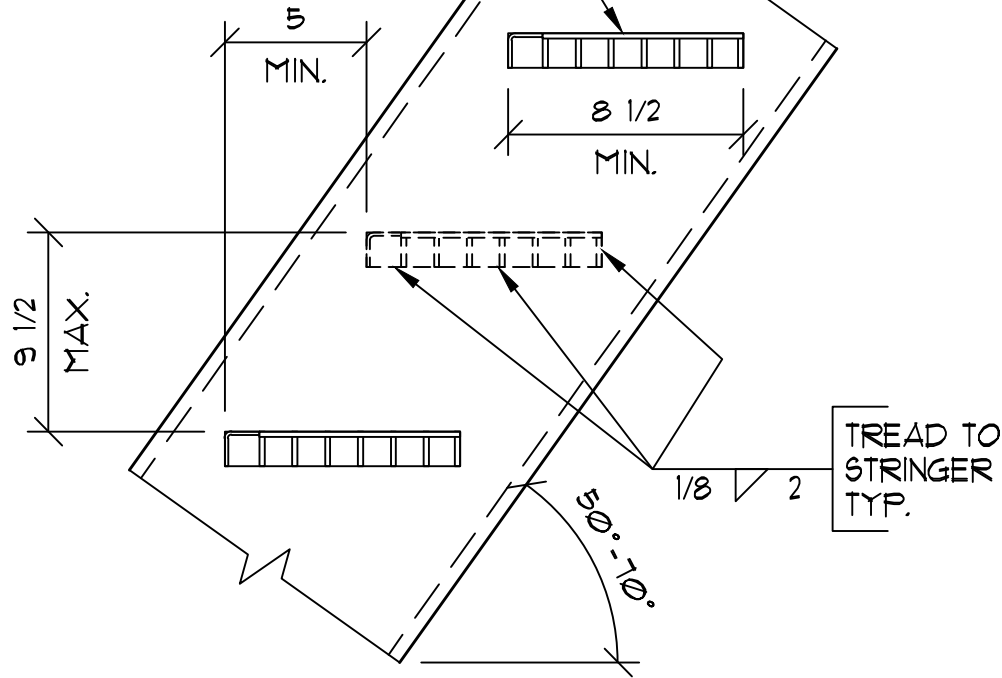

MC12x10.6
STRINGER

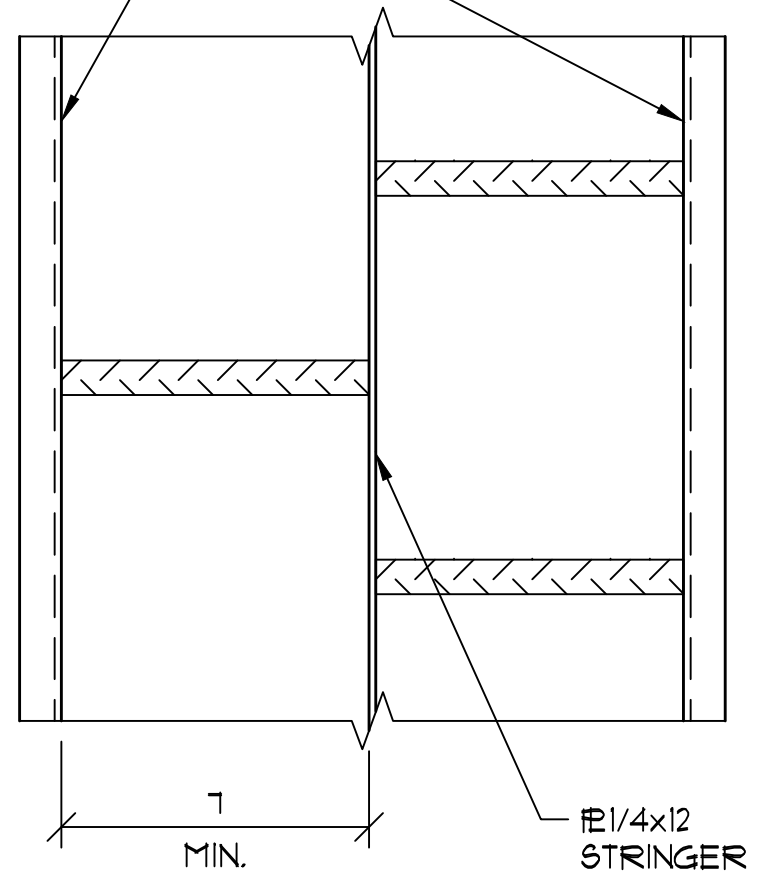

ALTERNATING TREAD STAIR / SHIP LADDER

1. NOTE NO CENTER STRINGER AT SIM. AND TREADS TO BE CONTINUOUS BETWEEN OUTSIDE STRINGER.

MISC.

S001